

# RAVENHILL STUDIO

2122 Cypress Ave, Los Angeles, CA 90065  
323.977.8532, contact@ravenhillstudio.com

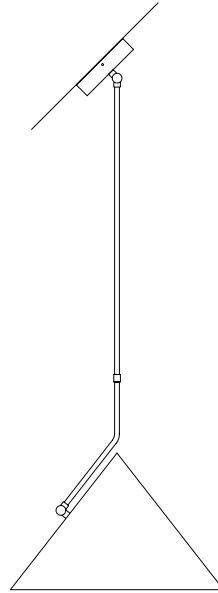

We recommend installation of our Slide Drop Pendant by a professional electrician. Please share this guide with them and ensure they read the instructions completely before beginning assembly.

We recommend finding a clean and level surface to assemble this fixture and consider having a helper nearby in case you need an extra set of hands.

Your Slide Drop Pendant for Sloped Ceiling conditions comes packaged in (3) different subassemblies. Your package also contains (1) miscellaneous contents envelope, and (1) bulb.

## (1) Shade Assembly

- Shade
- Swivel Assembly
- Bent Arm
- Socket Assembly
- Shade Nut
- Electrical Wires
- Coupler

## (1) Misc Contents Envelope

- Threadlocker Packet
- Wire Nuts
- Fire Enclosure Mounting Screws
- Nitrile Gloves  
(recommended for installation)

## (1) Light Bulb

## (1) Drop Tube Assembly

- Drop Tube
- Steel Hex Nut
- Swivel Assembly
  - Male Swivel Half & Female Swivel Half
  - Swivel Spring
  - Swivel Washer
  - Swivel Screw
  - Swivel Threaded Nipple

## (1) Canopy Assembly

- Canopy
- Mounting Bracket
- Grounding Screw
- (3) Thumb Screws

Included with your Slide fixture are either a 5 or 7 watt LED bulb depending on fixture size.

The bulbs are warm white (2700K) G16.5s or G25s and each delivers either 450 or 800 lumens.

The bulbs are JA8 certified and have a 15,000 hr lifetime.

G16.5 bulb or G25 recommended. 10W Max

 **CAUTION:** Before starting, turn off power at main circuit power.

SHADE ASSEMBLY

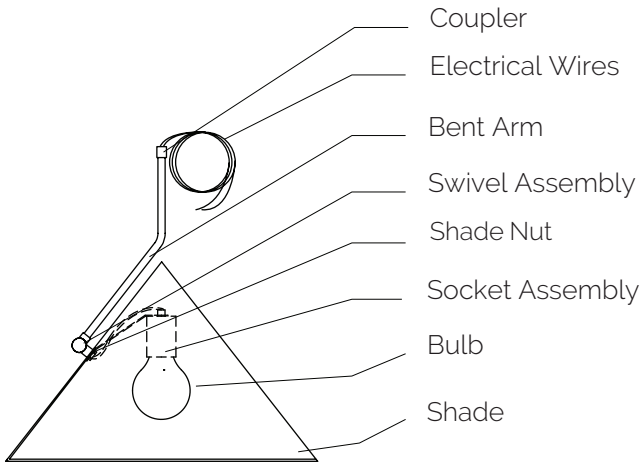

DROP TUBE ASSEMBLY

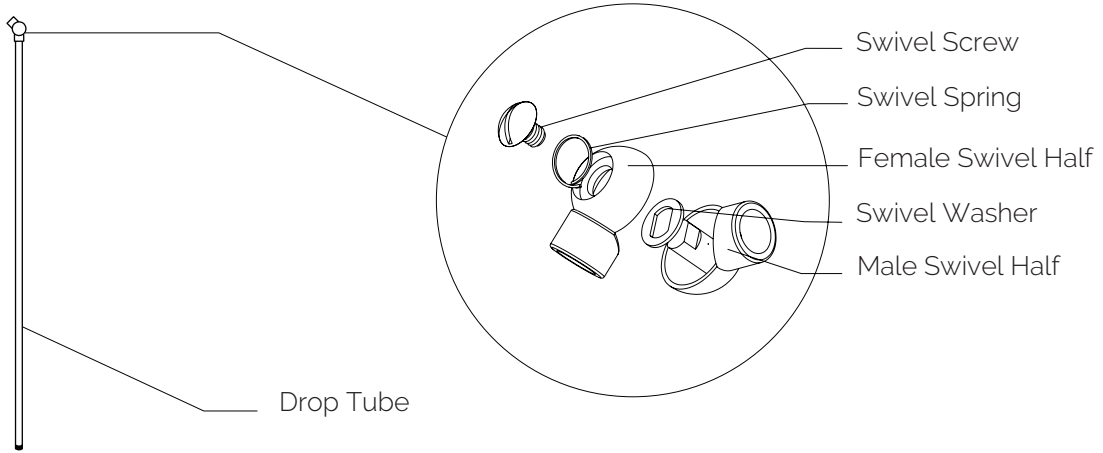

CANOPIE ASSEMBLY

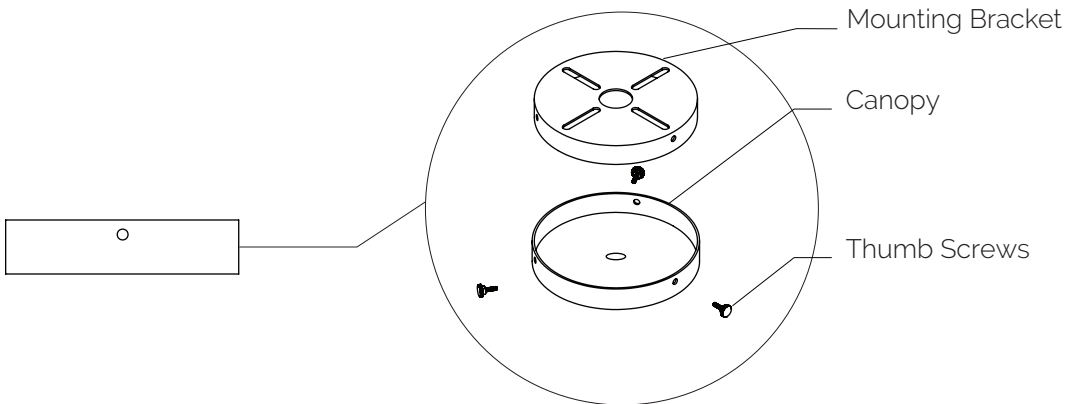

Your Slide fixture includes a fabric covered Shade which is vulnerable to staining if care is not taken. Before installing or adjusting your Slide fixture it is highly recommended to clean hands and wear gloves and to only adjust the Slide Shade as described in notes below. Failure to do so may result in smudges or stains.

1. Unpack your box and open the black Misc Contents envelope containing the Threadlocker Packet, Wire Nuts, Mounting Screws and Gloves. Put on the Gloves and set the remaining parts aside.

2. Grab the end of the Bent Arm and tilt it up to remove the cardboard insert, taking time to set aside the Light Bulb and Canopy Assembly bag.

3. Place the Shade Assembly on a clean and level surface making sure to leave the protective plastic cover on the Shade. Gently raise Bent Arm so that the Coupler is parallel to the surface when Shade is lying flat. It may be necessary to use a slotted screwdriver (not provided) to loosen and tighten the Swivel Screw as necessary.

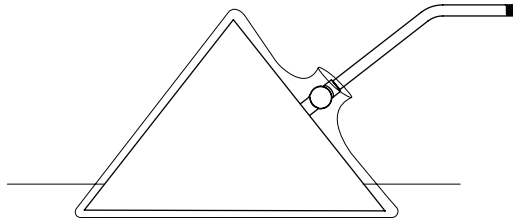

4. Unpack Drop Tube Assembly from box (Assembly may be in separate box) and remove plastic netting. Unbundle wires from the Shade Assembly and thread Electrical Wires through the threaded end of the Drop Tube Assembly. Place Threadlocker on threads of the Drop Tube Assembly and then tighten to firmly secure Bent Arm and Drop Tube Assembly together.

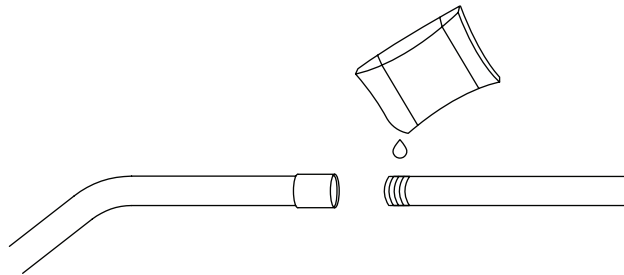

5. Disassemble the Swivel Assembly that comes attached at the end of the Drop Tube. Take special care to not lose any of the small parts contained in the Swivel Assembly.

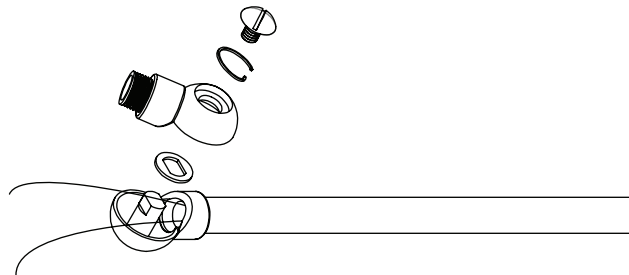

6. Loop the Electrical Cords around the Male Swivel Half (attached to Drop Assembly) as shown in Fig. 1. Place Swivel Washer on top of looped cords (Fig. 2). Place Female Swivel Half over looped cords and Swivel Washer (Fig. 3). Position the Swivel Spring and Swivel Screw in place (Fig. 4/5). Tighten the Swivel Screw with flathead screw driver.

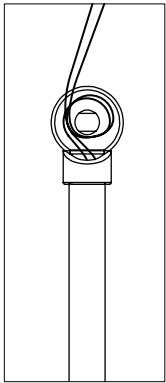

Fig. 1

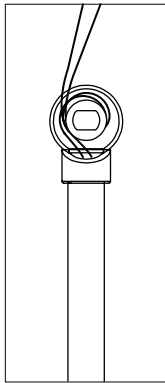

Fig. 2

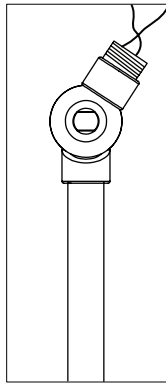

Fig. 3

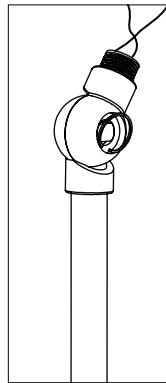

Fig. 4

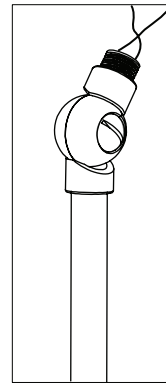
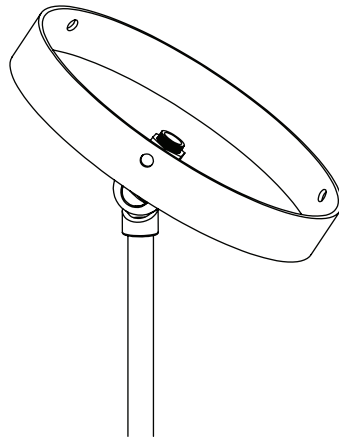

Fig. 5

7. Place the threaded end of the Swivel Assembly through the center hole in the Canopy. Tighten Steel Hex Nut around threading on inside of the Canopy.



8. Connect the Electrical Wires to junction box using Wire Nuts.

9. Secure the Mounting Bracket to the junction box with the Mounting Screws included in your Misc Contents envelope.

10. Before connecting the Canopy to the Mounting Bracket, it is important to make sure that the Mounting Bracket is firmly secured to the junction box, and that the Swivel and Canopy are properly oriented with the slope of the ceiling. To do so, determine the location of the side screw holes on the Mounting Bracket and align them to the Canopy so that the Swivel is in line with the ceiling slope. It may be necessary to loosen and tighten the Steel Hex Nut inside the Canopy to achieve the desired orientation.

11. Slip the Canopy over the Mounting Bracket and secure the Canopy with the Thumb Screws included. Make sure Drop Tube is plumb and securely tighten the Swivel Screw.

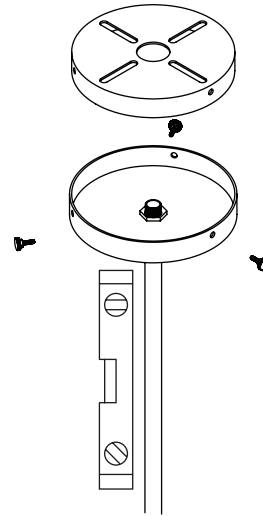

12. To adjust the Shade, grab the internal socket assembly and use it as a lever to set the Shade to the desired orientation, using a level if necessary. Once set, securely tighten the Swivel Screw with a slotted screwdriver.

13. Remove protective plastic covering from the Slide Shade by tearing the bag or carefully using scissors or knife.

14. Screw in the Light Bulb, turn on and enjoy!

#### NOTES / TROUBLESHOOTING:

Your Slide fixture comes with an adjustable Swivel joint that allows great versatility in how Slide can cast light. To adjust the Shades first grab the internal Socket Assembly before loosening and tightening the Swivel Screw. A half a turn of the Swivel Screw should be all that is needed to loosen the Swivel joint enough to adjust the Shade angle.

Make sure to fully tighten the Swivel Screw after finalizing shade orientation to ensure Shade doesn't move over time.

The Shade is secured and aligned to the Bent Arms in our Studio by tightening the Shade Nut inside the Shade. In some rare cases this Shade Nut might need to be loosened to fine tune the Shade to hang level and then tightened again.

To clean your Slide Shade it is recommended to use compressed air to blow away dust and dirt particles. Avoid using water or a vacuum to clean your Slide Shade.

Due to the delicate nature of the fabric covered Shades it is highly recommended to clean hands and wear gloves before installing or adjusting your Slide fixture.