

RAVENHILL STUDIO

2122 Cypress Ave, Los Angeles, CA 90065
323.977.8532, contact@ravenhillstudio.com

Pearl Junction Box Requirements

Our Pearl Family of fixtures has been designed with several canopy and mounting options, so some thought must be given to choosing the right junction boxes or canopies for successful installation. We encourage you to share this document and our installation instructions with your installer prior to installation to ensure the desired result.

NOTE: Pearl Seamless is designed to be installed with no visible canopy and can be installed on just about any junction box. Please refer to the Pearl Seamless installation instructions (available on our website) for more junction box details.

PEARL 3.5" CANOPY

For a minimal reveal and easy installation, using our 3.5" Canopy with Pearl allows the canopy to hide behind the globe, setting the fixture elegantly off of the wall.

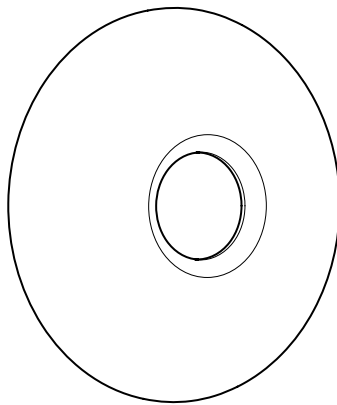

PEARL 3.5" BRACKET

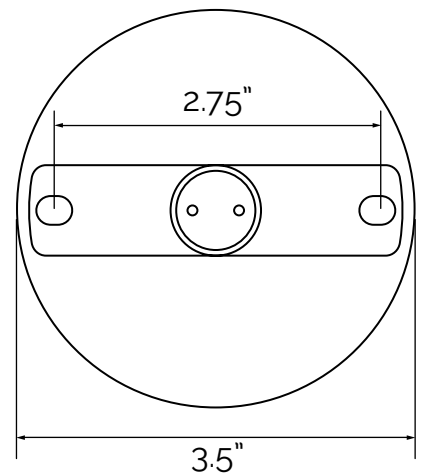

MUD RING

For ease and success of installation, we recommend mud rings mounted on 4" hex junction boxes with screw mounting holes spaced 2.75" apart. The only concern with using mud rings has to do with ensuring that the finish wall opening is kept tight to the mud ring and under 3.5" wide so that the 3.625" canopy fully covers the junction box.

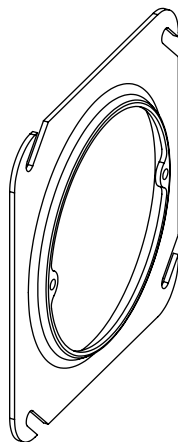

3.5" ROUND PAN

A stock 3.5" round electrical pan with screw mounting holes spaced 2.75" apart is a great option when mounting Pearl with a 3.5" canopy. Our Pearl 3.5" canopy actually has a 3.625" diameter, and is designed to be installed with tight tolerances to cover a 3.5" round pan, which typically has a 3.375" diameter. Care should be taken to ensure the finish wall opening is kept tight to the pan and under 3.5" wide so that the canopy fully covers the junction box.

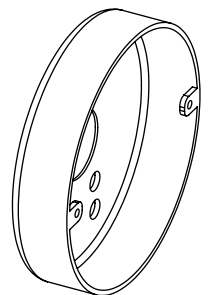

RAVENHILL STUDIO

2122 Cypress Ave, Los Angeles, CA 90065
323.977.8532, contact@ravenhillstudio.com

Pearl Junction Box Requirements

Our Pearl Family of fixtures has been designed with several canopy and mounting options, so some thought must be given to choosing the right junction boxes or canopies for successful installation. We encourage you to share this document and our installation instructions with your installer prior to installation to ensure the desired result.

NOTE: Pearl Seamless is designed to be installed with no visible canopy and can be installed on just about any junction box. Please refer to the Pearl Seamless installation instructions (available on our website) for more junction box details.

PEARL 4.5" CANOPIES

Our Pearl Pull Chain comes standard with 4.5" canopy and we also offer a wider 4.5" canopy option for our standard Pearl fixtures. These canopies are the best option when installing on an existing junction box where the smaller diameter of our 3.5" canopy will not work. The 4.5" canopies come with crossbars that can accommodate a number of different junction box types. When mounting Pearl with 4.5" canopies, take care to ensure the finish wall opening is kept tight to the pan and under 4.5" wide so that the canopy fully covers the junction box.

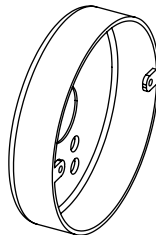
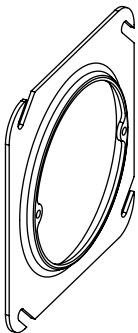

PEARL 4.5" & PULL CHAIN BRACKETS

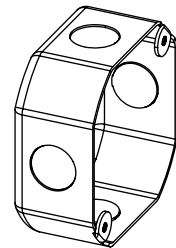
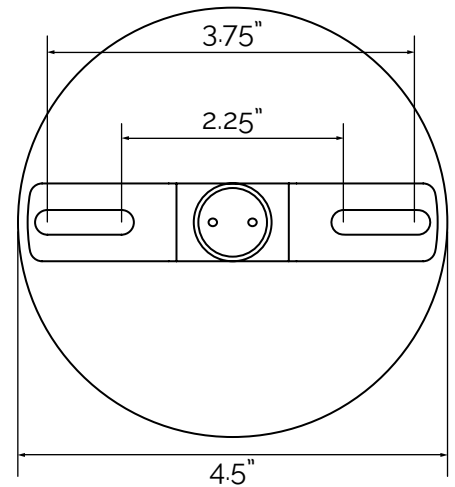
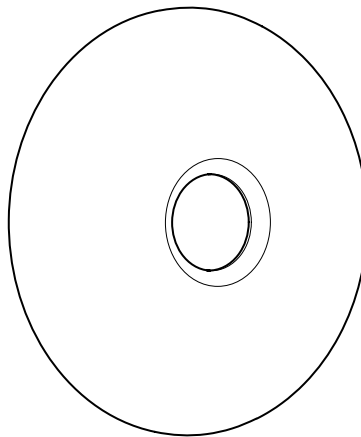

MUD RING

For ease and success of installation, we recommend mud rings mounted on 4" hex junction boxes with screw mounting holes spaced 2.75" apart. The only concern with using mud rings has to do with ensuring that the finish wall opening is kept tight to the mud ring and under 3.5" wide so that the 3.625" canopy fully covers the junction box.

3.5" ROUND PAN

A stock 3.5" round electrical pan with screw mounting holes spaced 2.75" apart is a great option when mounting Pearl with a 3.5" canopy. Our Pearl 3.5" canopy actually has a 3.625" diameter, and is designed to be installed with tight tolerances to cover a 3.5" round pan, which typically has a 3.375" diameter. Care should be taken to ensure the finish wall opening is kept tight to the pan and under 3.5" wide so that the canopy fully covers the junction box.

4" OCTAGON

Where a larger 4" octagon box is present and no alterations are desired, 4.5" Canopy will cover. Please make sure that the wall is well prepared tightly to the box. **Note that 4" square boxes are larger than octagon boxes and will not work.**